

## DISASSEMBLY

### 1. REMOVE SUNSHADE TRIM STOPPER

- (a) Remove the screw and stopper.
- (b) Employ the same manner described above to the other side.

### 2. REMOVE SUNSHADE TRIM

### 3. REMOVE SIDE GARNISHES

### 4. REMOVE SLIDING ROOF GLASS

Remove the 4 nuts and glass.

### 5. REMOVE ROOF DRIP CHANNEL

Using a screwdriver, remove the roof drip channel.

HINT:

Tape the screwdriver tip before use.

### 6. REMOVE CONTROL RELAY AND DRIVE GEAR ASSEMBLY

- (a) Disconnect the connectors.
- (b) Remove the bolt and relay.

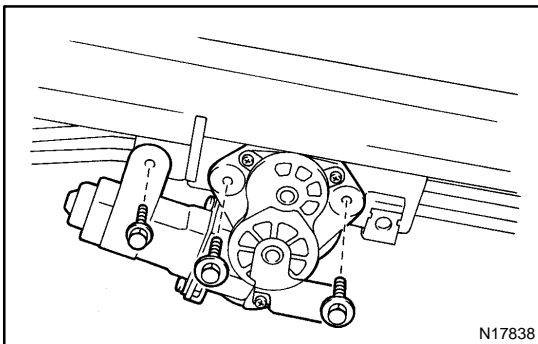

- (c) Remove the 3 bolts and drive gear assembly.

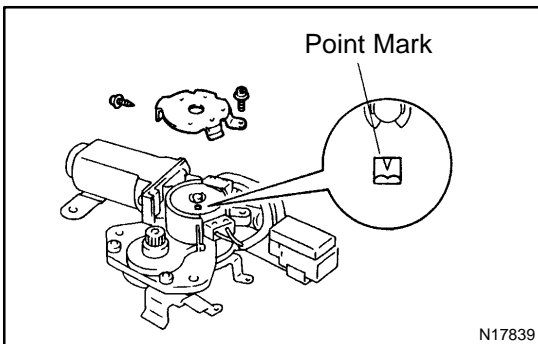

- (d) Remove the screw and cam plate cover.
- (e) Remove the large screw, washers and shims.
- (f) Turn the drive shaft with a screwdriver to align the housing and gear point mark, as shown.
- (g) Install the cam plate cover and screw.

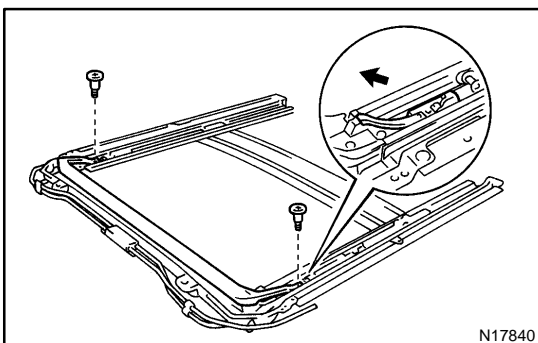

### 7. REMOVE WIND DEFLECTOR PANEL

Remove the 2 screws and panel.

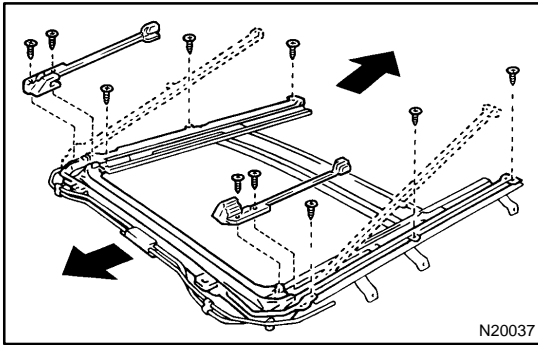
**8. REMOVE SLIDING ROOF HOUSING**

- (a) Remove the 4 screws with casing pipe stoppers.
- (b) Remove the 6 screws and housing.

**9. REMOVE DRIVE RAIL**

- (a) Pull off the cable of drive rail from the casing pipe.
- (b) Slide the drive rail forward, then remove it.

**10. ADJUST DRIVE RAIL (See page [BO-57](#) )**