

# 12 TRANSFER AND FRONT DRIVE AXLE

6. Only if you must remove the wheel hub with the brake disc, or if the adjusting nut requires replacement, remove the adjusting nut as indicated in Fig. 4-11.

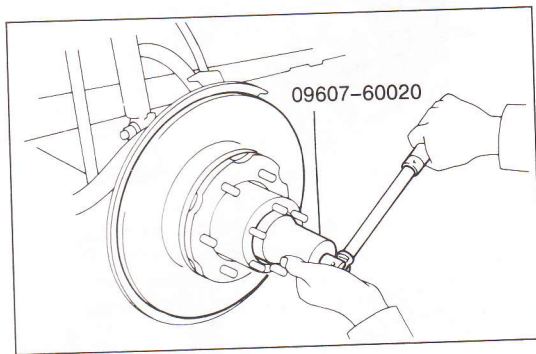

Fig. 4-11. Toyota service tool being used to remove adjusting nut from stub axle.

## To repair automatic-locking free wheel hub:

1. Remove the snap ring indicated in Fig. 4-12. Remove the outer thrust washer. Remove the inner hub subassembly from the hub body. See Fig. 4-13.

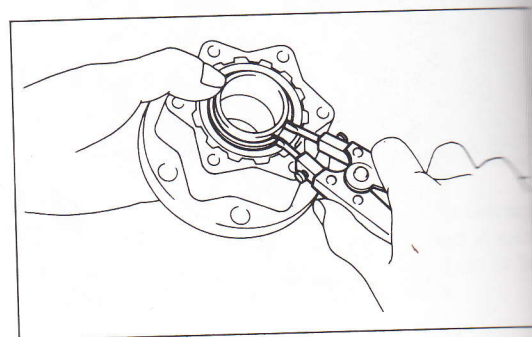

Fig. 4-12. Snap ring being removed prior to removing inner hub subassembly from hub body.

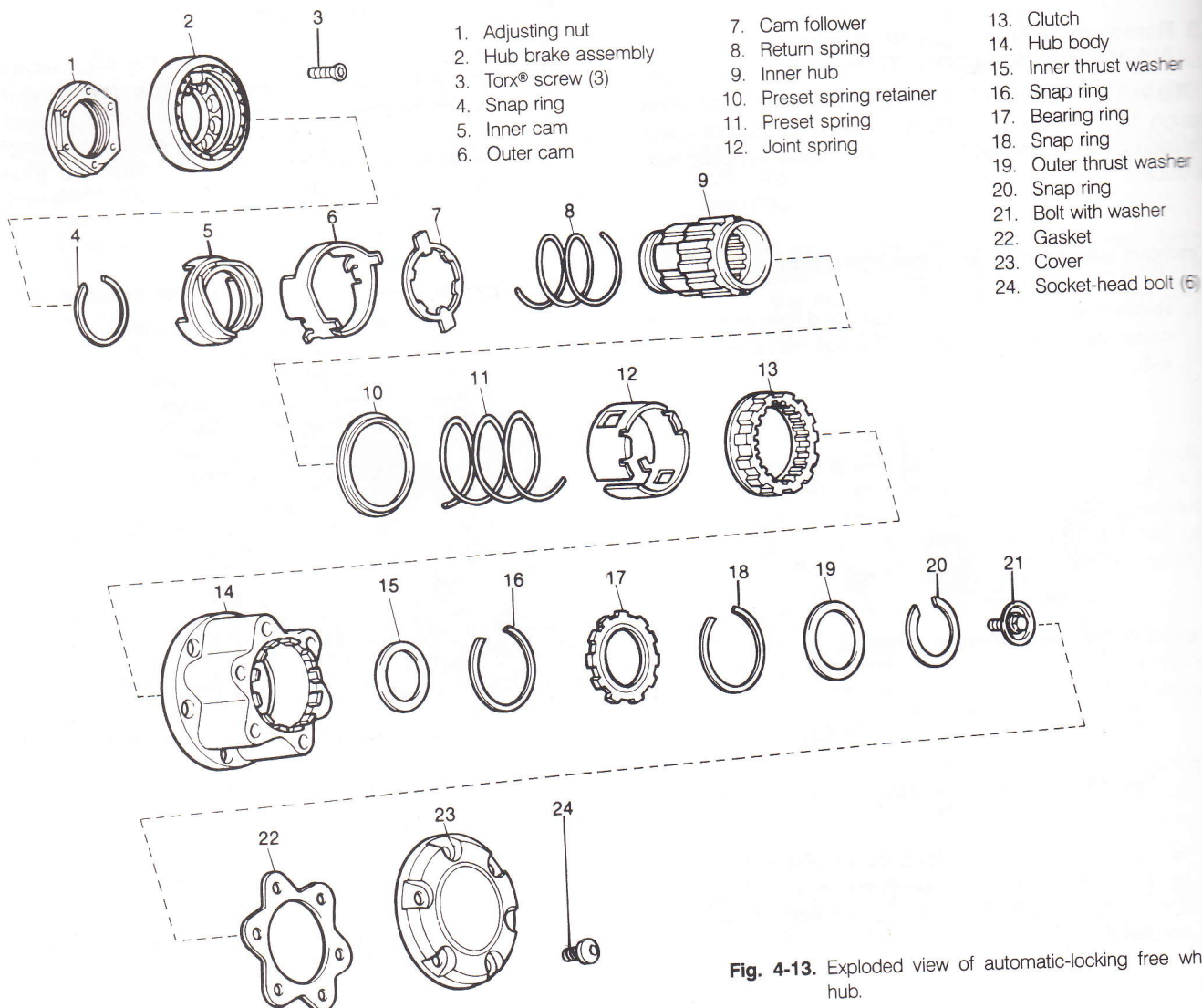

Fig. 4-13. Exploded view of automatic-locking free wheel hub.