

ON-VEHICLE INSPECTION

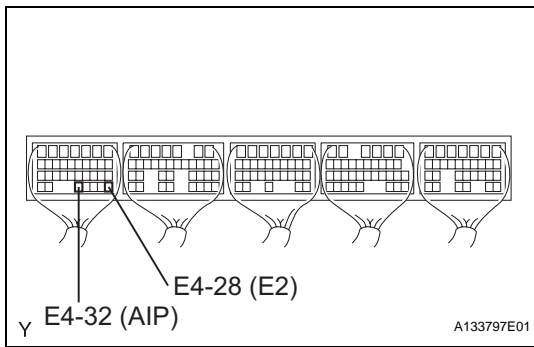

1. INSPECT PRESSURE SENSOR

- (a) Turn the ignition switch to the ON position.
- (b) Measure the voltage between terminals E4-32 (AIP) and E4-28 (E2) of the ECM connector.

Voltage:

1.0 to 2.2 V

If the voltage is not as specified, replace the pressure sensor, wire harness or ECM.

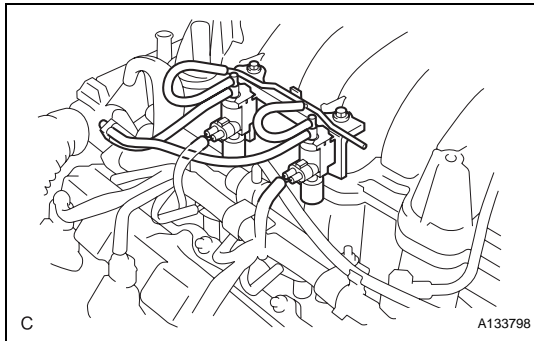

2. INSPECT VSV FOR AIR INJECTION SYSTEM

- (a) Disconnect the connector from the VSV (Procedure "A").
- (b) Disconnect the 2 vacuum hoses from the VSV (Procedure "B").

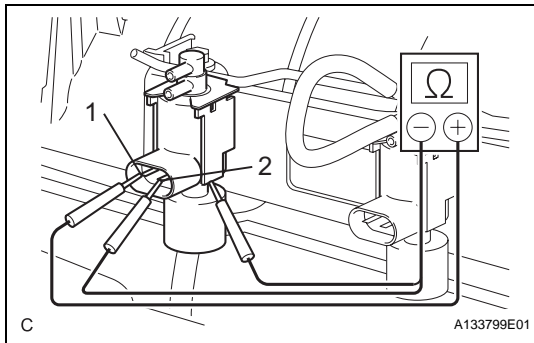

- (c) Using an ohmmeter, measure the resistance between the terminals (Procedure "C").

Resistance

Tester Connection	Specified Condition
1 - 2	33 to 39 Ω at 20°C (68°F)
1 - Body ground	10 MΩ or higher
2 - Body ground	10 MΩ or higher

If the resistance is not as specified, replace the VSV.

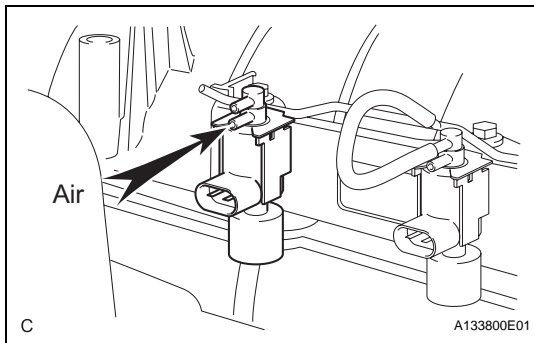

- (d) Check that air does not flow from the port as shown in the illustration (Procedure "D").
If the result is not as specified, replace the VSV.

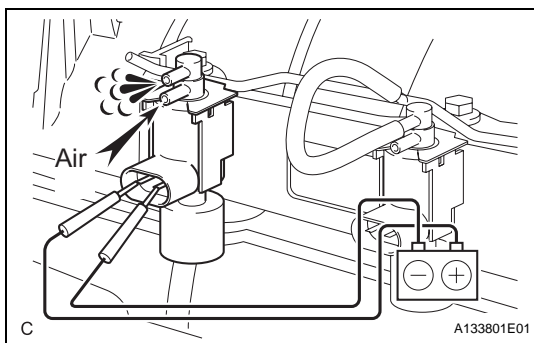

- (e) Apply positive battery between the terminals, and check that air flows from the port (Procedure "E").
If the result is not as specified, replace the VSV.
 - (f) Connect the 2 vacuum hoses to the VSV (Procedure "F").
- NOTICE:**
Be sure to connect the vacuum hoses correctly.
- (g) Connect the connector to the VSV (Procedure "G").
 - (h) Perform procedures "A" to "G" for the other VSV.

EC